



Expires: January 31, 2025

Olympic Region - Firewood Cutting Permit

A Discover Pass is required to access DNR recreation lands. For information on how to purchase the pass, visit www.discoverpass.wa.gov or call 1-866-320-9933. Find out where you'll need a Discover Pass on DNR-managed state trust lands at www.dnr.wa.gov/recreation.

Permit must be in vehicle window and available upon request

Olympic Region Firewood hotline: 360-374-2886

Firewood Information: http://www.dnr.wa.gov/htdocs/olympic/firewood_permits/index.html

Do not cut any standing trees, snags, or blow-down timber marked with blue paint.

Only cut within the boundaries of the unit(s) outlined on the map, and only within 100 feet from truck roads. Units available for firewood cutting are marked on the map with //// in the interior of the unit.

Firewood is for personal use only

- 1) Limit of 6 cords per family with this permit.
- 2) Cut only wood that is dead and on the ground.
- 3) Cedar scraps may be taken as long as they are no larger than 1 cubic foot in size.
- 4) Firewood cutting will be allowed during the closed season if the following conditions are met:
 - o No cutting is allowed on fire precaution level 2 or above. Call 1-800-527-3305 for this information.
 - o All fire tool requirements must be met for power saws, including approved spark arresters, fire extinguishers, and shovel.
 - o Smoking is not allowed in unit on a level 2 or above day, except in vehicles.

Obey all signs posted in the unit

- 5) Do not disturb ANY planted seedlings.
- 6) Motorized equipment and/or vehicles must stay on roads (do not drive on skid trails).
- 7) **No removal or cutting of firewood is allowed more than 100 feet from truck roads.**

Any false statement made in this application or violation of these terms is punishable as a Gross Misdemeanor.

RCW 79.15.440

This permit may be voided by any State DNR Forester on demand.

The firewood area will be closed if abuse or permit violations occur.

Please report any violations to DNR Olympic Region at 360-374-2800. Report Fires to DNR at 1-800-562-6010.

The following information must be provided to validate this permit

Name: _____

Address: _____ Discover Pass Number: _____

Phone Number: _____ Vehicle Make/Model/Color: _____

Note: DNR may have burned slash piles after the close of fire season, so available firewood may be limited at some locations

DRIVING MAP

SALE NAME: MORSE SIEBERT DIVIDE
 AGREEMENT #: 30-102260
 TOWNSHIP(S): T29R5W
 TRUST(S): Common School and Indemnity (3), State Forest Transfer (1)

REGION: Olympic Region
 COUNTY(S): Clallam
 ELEVATION RGE: 1370 2540

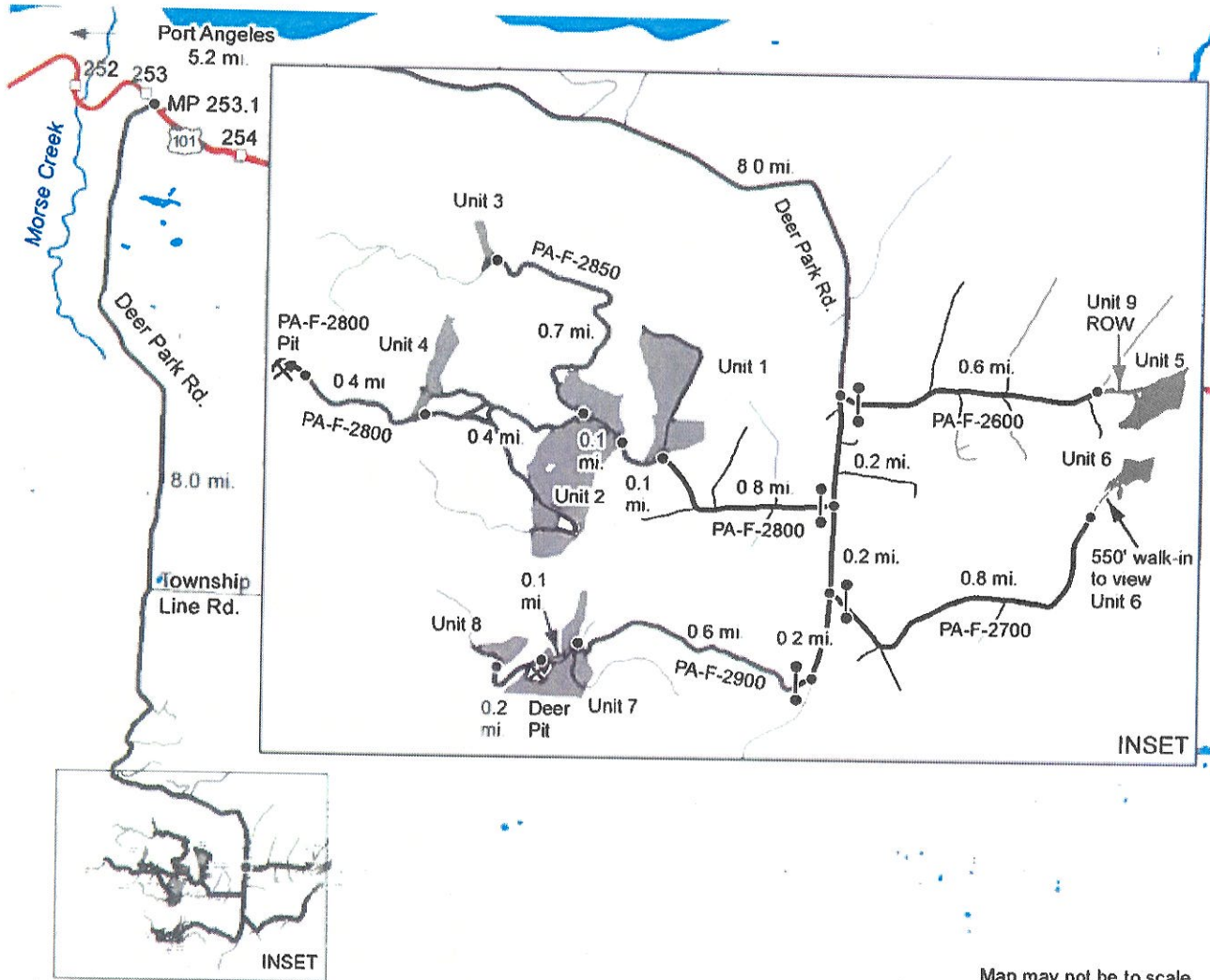

Map may not be to scale

- Haul Route
- View Only Route
- Other Road
- Highway
- Distance Indicator
- Gate (AA1 Key)
- Rock Pit
- Timber Sale Unit

DRIVING DIRECTIONS:

From Port Angeles, travel east on Highway 101 for 5.2 mi. Turn right onto Deer Park Rd. (MP 253.1) & travel 8.0 miles to the PA-F-2600 jct.

UNIT 1: From PA-F-2600 jct., continue on Deer Park Rd. for 0.2 mi. Turn right onto the PA-F-2800 & drive 0.8 mi. to arrive at Unit 1.

UNIT 2: From Unit 1, continue 0.1 mi. on the PA-F-2800 to arrive at Unit 2.

UNIT 3: From Unit 2, continue 0.1 mi. on the PA-F-2800. Turn right onto the PA-F-2850. Drive 0.7 mi. to arrive at Unit 3.

UNIT 4: From the PA-F-2800/PA-F-2850 jct., drive 0.4 mi. on the PA-F-2800 to arrive at Unit 4.

PA-F-2800 PIT: From Unit 4, drive 0.4 mi. on the PA-F-2800 to arrive at the PA-F-2800 Pit.

UNIT 9 ROW/UNIT 5: From the Deer Park Rd./PA-F-2600 jct., drive 0.6 mi. on the PA-F-2600 rd. to arrive at Unit 9 ROW. Unit 5 is walk-in only through Unit 9 ROW until road work is completed.

UNIT 6: From the Deer Park Rd./PA-F-2600 jct., drive 0.4 mi. on Deer Park Rd. & turn left onto the PA-F-2700. Drive 0.8 mi., which is the end of the PA-F-2700. Unit 6 is walk-in only from there (approx. 550') until road work is completed.

UNIT 7: From the Deer Park Rd./PA-F-2700 jct., drive 0.2 mi. & turn right onto the PA-F-2900. Drive 0.6 mi. to arrive at Unit 7.

DEER PIT: From Unit 7, continue on the PA-F-2900 for 0.1 mi. to arrive at Deer Park Pit.

UNIT 8: From Deer Park Pit, continue on the PA-F-2900 for 0.2 mi. to arrive at Unit 8.



TIMBER SALE MAP

SALE NAME: MORSE SIEBERT DIVIDE
AGREEMENT #: 30-102260
TOWNSHIP(S): T29R5W
TRUST(S): Common School and Indemnity (3), State Forest Transfer (1)

REGION: Olympic Region
COUNTY(S): Clallam
ELEVATION RGE: 1370-2540

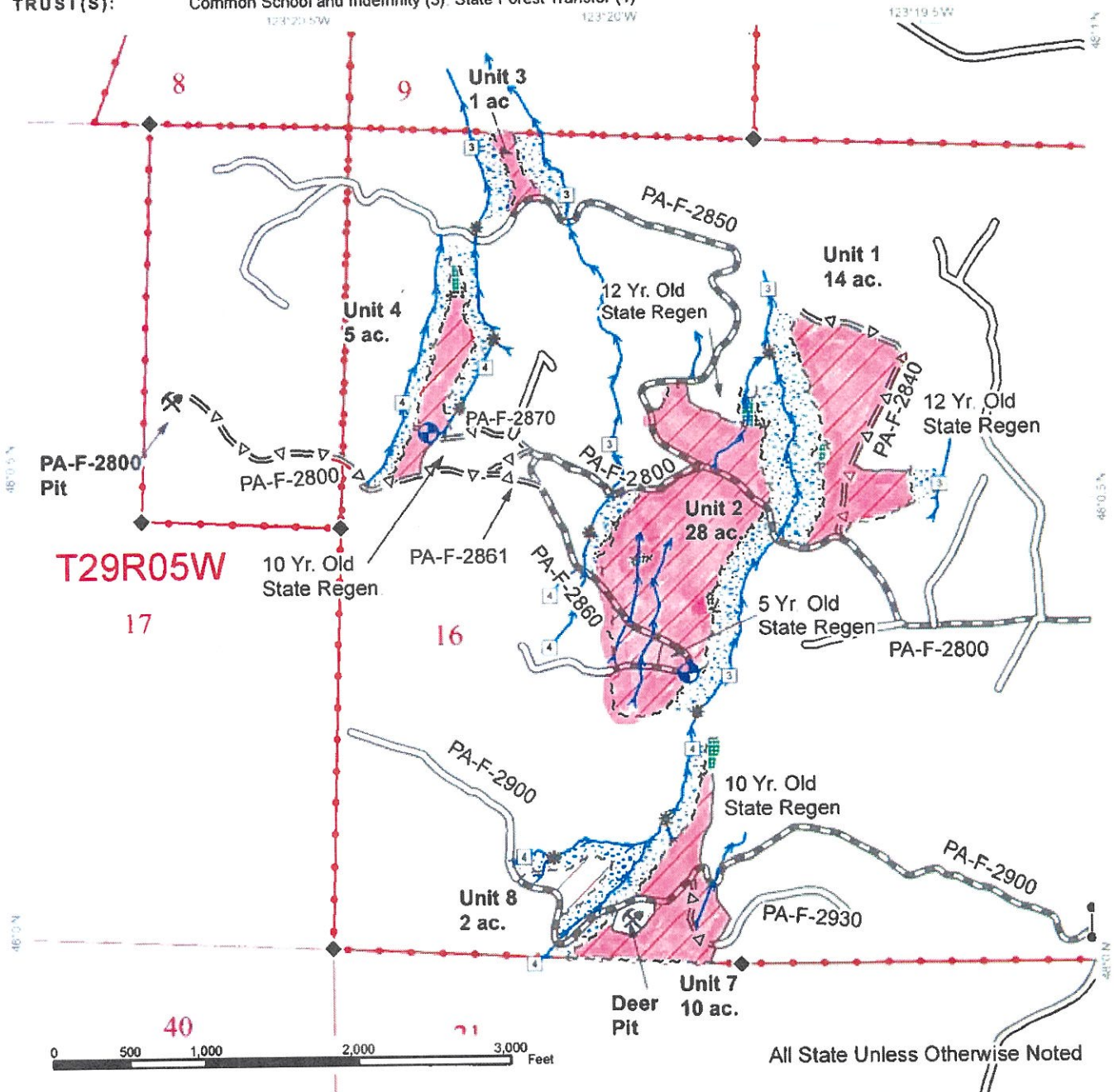

~ ~ ~ Sale Boundary Tags	County Road	Variable Retention Harvest	FIREWOOD CUTTING AREA
~ ~ ~ Leave Tree Tags	Existing Roads	Public Land Survey Townships	
~ ~ ~ Right of Way Tags	Optional Construction	Public Land Survey Sections	
Property Line	Optional Pre-Haul Maintenance	DNR Managed Lands	
Timber Type Change	Required Construction	Stream Type	
Gate	Required Pre-Haul Maintenance	Stream Type Break	
Landing - Proposed	Leave Tree Area	Streams	
Rock Pit	Riparian Mgt Zone	Survey Monument	
	Wetlands - Non-forested		
	Wetland Mgt Zone		

*All streams Type 5s Unless Otherwise Noted



TIMBER SALE MAP

SALE NAME: MORSE SEBERT DIVIDE
AGREEMENT #: 30-102260
TOWNSHIP(S): T29R5W
TRUST(S): Common School and Indemnity (3) State Forest Transfer (1)

REGION: Olympic Region
COUNTY(S): Clallam
ELEVATION RGE: 1370-2540

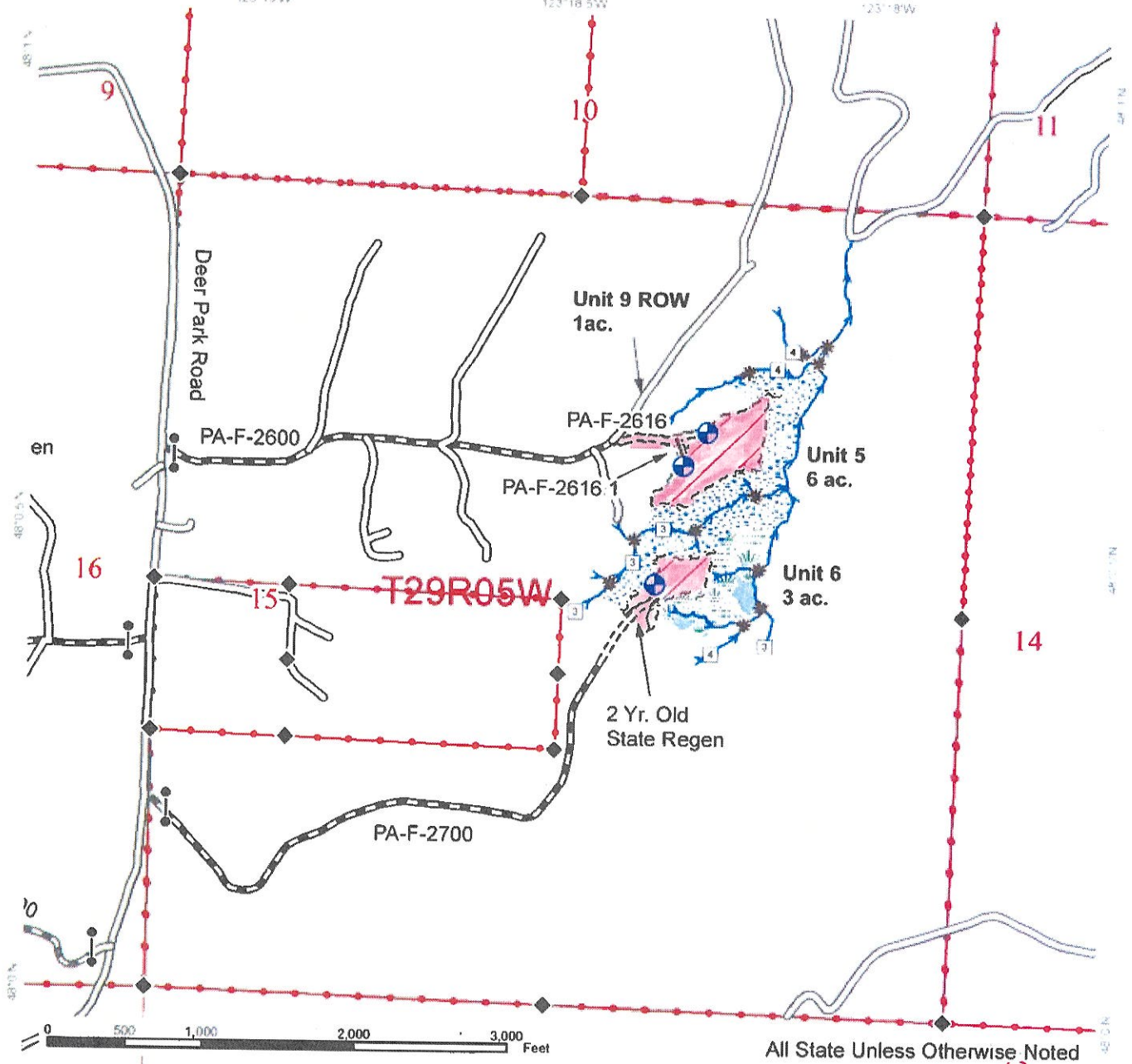

~ ~ ~ Sale Boundary Tags	County Road	Variable Retention Harvest	FIREWOOD CUTTING AREA
~ ~ ~ Leave Tree Tags	Existing Roads	Public Land Survey Townships	
~ ~ ~ Right of Way Tags	Optional Construction	Public Land Survey Sections	
• • • Property Line	Optional Pre-Haul Maintenance	DNR Managed Lands	
— Timber Type Change	Required Construction	Stream Type	
• Gate	Required Pre-Haul Maintenance	* Stream Type Break	
• Landing Proposed	Leave Tree Area	Streams	
• Rock Pit	Riparian Mgt Zone	◆ Survey Monument	
	Wetlands - Non-forested		
	Wetland Mgt Zone		

*All streams Type 5s Unless Otherwise Noted